



ZEPHYR[®]
TOOL
GROUP
LOK-FAST

Torque Control Tools



LOK-FAST

Torque Control Tools

Torque Control Ordering System	03
Quick Release System	04-05
Pistol Grip Tools	
L-Angle Head	
0.25" Thick Head (T2 - T3)	06
0.33" Thick Head (T2 - T4)	07
0.47" Thick Head (T2 - T5)	08
Extended L-Angle Head	
0.25" Thick Head (T2 - T3)	09
0.33" Thick Head (T2 - T4)	10
0.47" Thick Head (T2 - T5)	11
Inline (T2 - T5)	12
Straight Angle Motor Tools	
Flat Offset	
0.25" Thick Head (T2 - T3)	13
0.33" Thick Head (T2 - T4)	14
0.47" Thick Head (T2 - T5)	15
20° Offset	
0.25" Thick Head (T2 - T3)	16
0.33" Thick Head (T2 - T4)	17
0.47" Thick Head (T2 - T5)	18
Right Angle 90° (T2 - T5)	19- 20
Torque Control Battery Operated	21 - 22



LOK-FAST

Features of Lok-Fast Torque Control Tools

We pride ourselves at making the very best tools on the market. They are easy to use (QRS® Sockets) and versatile to meet all your installation and removal needs.

Tools Configurations:

The Lok-Fast Torque Control Tools come in several configurations allowing for the operator to choose the tool best designed for his needs.

Versatility:

All the heads are designed to be 360 degree indexable and give a constant torque at any angle.

Ease of Use:

The QRS® Sockets allow for the quick and easy installation and removal of the hex tip with out the need for any other tooling. This eliminates excess down time and keeps the tool on the job longer.

Indexing Feature:

The tools are fully indexable (360°). No extra tooling is required to utilize the indexing mechanism, allowing for quick adjustments and increased versatility.





Torque Control Tool Part Number System

LTC -

STYLE

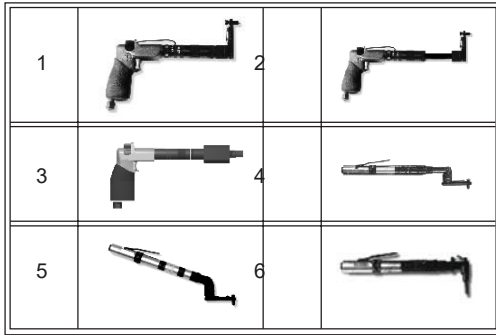

HEAD THICKNESS

2	=	0.25"
3	=	0.33"
4	=	0.46"

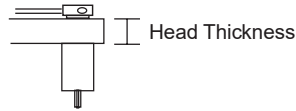

HEAD OFFSET

3	=	0.95"
5	=	2.10"
7	=	3.44"

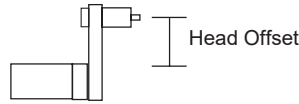

TORQUE RATING*

T2	=	15 to 25 in-lbs
T3	=	26 to 55 in-lbs
T4	=	40 to 80 in-lbs
T5	=	80 to 120 in-lbs

Important to note not all torque ratings are available for all head thicknesses and offsets. Refer to specific tool pages for details.

SOCKET HEX SIZE

7/32	=	21
1/4	=	25
9/32	=	28
5/16	=	31
11/32	=	34



SOCKET LENGTH

-	=	flush
B	=	0.5"
D	=	1.0"
F	=	1.5"
H	=	2.0"
L	=	3.0"
P	=	4.0"

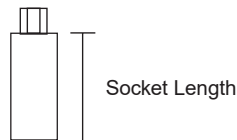

HEX TIP

5	=	1/16
6	=	5/64
8	=	3/32

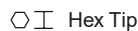

LOK-FAST



LOK-FAST

Torque Control Tooling Quick Release System®

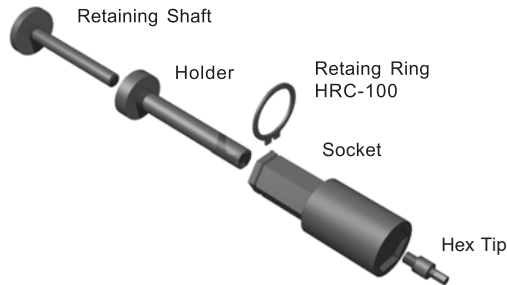

Ordering Information:

1. Select the required *Hex Tip Size*
2. Select the *Socket Hex Size*
3. Select the *Drive Hex Length (w)*
4. Select the *Socket Extension (x)*
5. Combine as shown below

Example: **LTSA25 - 25B5**

LTSA25 ----- 0.25" Long Socket Drive Hex
25 ----- 1/4" Socket Hex
B --- 1/2" Long Extended Socket
5 - 1/16" Hex Key

Hex Tip	Socket Hex	Complete Part #	Socket	Holder	Retaining Shaft
1/16 QRK - 5	7/32	LTSA(w) - 21(x)5	LTS(w) - 21(x)	LTH(w)(x)	LTRS(w)(x)
	1/4	LTSA(w) - 25(x)5	LTS(w) - 25(x)		
	9/32	LTSA(w) - 28(x)5	LTS(w) - 28(x)		
	5/16	LTSA(w) - 31(x)5	LTS(w) - 31(x)		
	11/32	LTSA(w) - 34(x)5	LTS(w) - 34(x)		
5/64 QRK - 6	7/32	LTSA(w) - 21(x)6	LTS(w) - 21(x)	LTH(w)(x)	LTRS(w)(x)
	1/4	LTSA(w) - 25(x)6	LTS(w) - 25(x)		
	9/32	LTSA(w) - 28(x)6	LTS(w) - 28(x)		
	5/16	LTSA(w) - 31(x)6	LTS(w) - 31(x)		
	11/32	LTSA(w) - 34(x)6	LTS(w) - 34(x)		
	3/8	LTSA(w) - 37(x)6	LTS(w) - 37(x)		
3/32 QRK - 8TC	5/16	LTSA(w) - 31(x)8	LTS(w) - 31(x)	LTH(w)(x)	LTRS(w)(x)
	11/32	LTSA(w) - 34(x)8	LTS(w) - 34(x)		
	3/8	LTSA(w) - 37(x)8	LTS(w) - 37(x)		
	7/16	LTSA(w) - 43(x)8	LTS(w) - 43(x)		

W	Head Thickness
25	0.25"
33	0.33"
47	0.47"

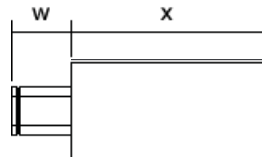

X	Socket Length
B	0.5"
D	1.0"
F	1.5"
H	2.0"
L	3.0"
P	4.0"



Torque Control Tooling

Quick Release System[®]
For use with LTC300 Series
(Inline Pistol Grip)



Ordering Information:

1. Select the required *Hex Tip Size*
2. Select the *Socket Hex Size*
3. Select the *Socket Length (x)*
4. Combine as shown below

Example: **LTSDSA21H5**

LTSDSA ----- Basic Socket Assy
21 ----- 7/32" Socket Hex
H --- 2" Long Extended Socket
5 - 1/16" Hex Key

Hex Tip	Socket Hex	Complete Part #	Socket	Holder	Retaining Shaft
1/16 QRK - 5	7/32	LTSDSA21(x)5	LTSDS21(x)	LTSDH(x)	LTSDRS(x)
	1/4	LTSDSA25(x)5	LTSDS25(x)		
	9/32	LTSDSA28(x)5	LTSDS28(x)		
	5/16	LTSDSA31(x)5	LTSDS31(x)		
	11/32	LTSDSA34(x)5	LTSDS34(x)		
5/64 QRK - 6	7/32	LTSDSA21(x)6	LTSDS21(x)	LTSDH(x)	LTSDRS(x)
	1/4	LTSDSA25(x)6	LTSDS25(x)		
	9/32	LTSDSA28(x)6	LTSDS28(x)		
	5/16	LTSDSA31(x)6	LTSDS31(x)		
	11/32	LTSDSA34(x)6	LTSDS34(x)		
3/32 QRK - 8TC	3/8	LTSDSA37(x)6	LTSDS37(x)	LTSDH(x)	LTSDRS(x)
	5/16	LTSDSA31(x)8	LTSDS31(x)		
	11/32	LTSDSA34(x)8	LTSDS34(x)		
	7/16	LTSDSA43(x)8	LTSDS43(x)		



X	Socket Length
H	2.0"
P	4.0"



Torque Control Tooling

Quick Release System®

For use with LTC600 Series

(Right Angle)

LOK-FAST

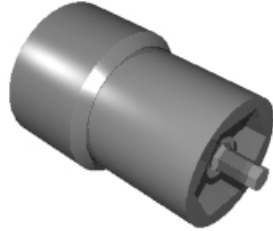

Ordering Information:

1. Select the required *Hex Tip Size*
2. Select the *Socket Hex Size*
3. Select the *Socket Length (x)*
4. Combine as shown below

Example: **LTRASA21H5**

LTRASA ----- Basic Tool
21 ----- 7/32" Socket Hex
H --- 2" Long Extended Socket
5 - 1/16" Hex Key

Hex Tip	Socket Hex	Complete Part #	Socket	Holder	Retaining Shaft
1/16 QRK - 5	7/32	LTRASA21(x)5	LTRAS21(x)	LTRAH(x)	LTRARS(x)
	1/4	LTRASA25(x)5	LTRAS25(x)		
	9/32	LTRASA28(x)5	LTRAS28(x)		
	5/16	LTRASA31(x)5	LTRAS31(x)		
	11/32	LTRASA34(x)5	LTRAS34(x)		
5/64 QRK - 6	7/32	LTRASA21(x)6	LTRAS21(x)	LTRAH(x)	LTRARS(x)
	1/4	LTRASA25(x)6	LTRAS25(x)		
	9/32	LTRASA28(x)6	LTRAS28(x)		
	5/16	LTRASA31(x)6	LTRAS31(x)		
	11/32	LTRASA34(x)6	LTRAS34(x)		
	3/8	LTRASA37(x)6	LTRAS37(x)		
3/32 QRK - 8TC	5/16	LTRASA31(x)8	LTRAS31(x)	LTRAH(x)	LTRARS(x)
	11/32	LTRASA34(x)8	LTRAS34(x)		
	3/8	LTRASA37(x)8	LTRAS37(x)		
	7/16	LTRASA43(x)8	LTRAS43(x)		



X	Socket Length
D	1.0"
F	1.5"
H	2.0"
L	3.0"
P	4.0"



LOK-FAST

Torque Control Tooling

LTC12 Series

0.25" Thick Head - (T2 - T3)



Ordering Information:

1. Select the *Head Offset* required (H)
2. Select *Nut Setting Torque* (T)
3. Select the *Socket Hex Size* needed
4. Select the *Socket Length* required (x)
4. Select the *Hex Tip* required
5. Combine Part Numbers as Shown Below

Example Extended Socket

LTC123T2 - 25B5

LTC12 ----- Basic Tool
3 ----- 0.95" Offset
T2 ----- 15 to 25 in-lbs. Torque Range
25 ----- 1/4" Socket Hex
B --- 1/2" Long Extended Socket
5 - 1/16" Hex Tip

(H)	Head Offset
3	0.95"
5	2.10"

(T)	Torque Range
T2	15 to 25 in - lbs
T3	26 to 55 in - lbs

(X)	Socket Length
B	0.5"
D	1.0"
F	1.5"
H	2.0"
L	3.0"
P	4.0"

Tool Data	
Performance Rated @	90 PSI
Air Inlet	1/4 N.P.T.
RPM (free speed)	T2-T3 = 600

Hex Tip	Socket Hex	Complete Part #
1/16	7/32	LTC12(H)(T) - 21(x)5
	1/4	LTC12(H)(T) - 25(x)5
	9/32	LTC12(H)(T) - 28(x)5
	5/16	LTC12(H)(T) - 31(x)5
5/64	11/32	LTC12(H)(T) - 34(x)5
	7/32	LTC12(H)(T) - 21(x)6
	1/4	LTC12(H)(T) - 25(x)6
	9/32	LTC12(H)(T) - 28(x)6
3/32	5/16	LTC12(H)(T) - 31(x)6
	11/32	LTC12(H)(T) - 34(x)6
	3/8	LTC12(H)(T) - 37(x)6
	5/16	LTC12(H)(T) - 31(x)8
3/32	11/32	LTC12(H)(T) - 34(x)8
	3/8	LTC12(H)(T) - 37(x)8
	7/16	LTC12(H)(T) - 43(x)8



Torque Control Tooling

LTC13 Series

0.33" Thick Head - (T2 - T4)



H	Head Offset
3	0.95"
5	2.10"
7*	3.44"

* Not available above T3

T	Torque Range
T2	15 to 25 in - lbs
T3	26 to 55 in - lbs
T4	40 to 80 in - lbs

X	Socket Length
-	flush
B	0.5"
D	1.0"
F	1.5"
H	2.0"
L	3.0"
P	4.0"

Tool Data	
Performance Rated @	90 PSI
Air Inlet	1/4 N.P.T.
RPM	T2 - T3 = 600 T4 = 400

Ordering Information:

1. Select the *Head Offset* required (H)
2. Select *Nut Setting Torque* (T)
3. Select the *Socket Size*
4. Select the *Socket Length* required (x)
4. Select the *Hex Tip* required
5. Combine Part Numbers as Shown Below

Example Extended Socket

LTC133T2 - 25B5

LTC13 ----- Basic Tool
3 ----- 0.95" Offset
T2 ----- 15 to 25 in-lbs. Torque Range
25 ----- 1/4" Socket Hex
B --- 1/2" Long Extended Socket
5 - 1/16" Hex Tip

Example Flush

LTC133T2 - 25 - 5

LTC13 ----- Basic Tool.
3 ----- 0.95" Offset
T2 ----- 15 to 25 in-lbs. Torque Range
25 ----- 1/4" Flush Socket Hex
5 - 1/16 Hex Tip

Hex Tip	Socket Hex	Complete Part #
1/16	7/32	LTC13(H)(T) - 21(x)5
	1/4	LTC13(H)(T) - 25(x)5
	9/32	LTC13(H)(T) - 28(x)5
	5/16	LTC13(H)(T) - 31(x)5
	11/32	LTC13(H)(T) - 34(x)5
5/64	7/32	LTC13(H)(T) - 21(x)6
	1/4	LTC13(H)(T) - 25(x)6
	9/32	LTC13(H)(T) - 28(x)6
	5/16	LTC13(H)(T) - 31(x)6
	11/32	LTC13(H)(T) - 34(x)6
3/32	3/8	LTC13(H)(T) - 37(x)6
	5/16	LTC13(H)(T) - 31(x)8
	11/32	LTC13(H)(T) - 34(x)8
	3/8	LTC13(H)(T) - 37(x)8
	7/16	LTC13(H)(T) - 43(x)8



LOK-FAST

Torque Control Tooling

LTC14 Series

0.46" Thick Head - (T2 - T5)



H	Head Offset
3	0.95"
5	2.10"
7	3.44"

T	Torque Range
T2	15 to 25 in - lbs
T3	26 to 55 in - lbs
T4	40 to 80 in - lbs
T5	80 to 120 in - lbs

X	Socket Length
-	flush
B	0.5"
D	1.0"
F	1.5"
H	2.0"
L	3.0"
P	4.0"

Tool Data

Performance Rated @	90 PSI
Air Inlet	1/4 N.P.T.
RPM (free speed)	T2 - T3 = 600 T4 - T5 = 400

Ordering Information:

1. Select the *Head Offset* required (H)
2. Select *Nut Setting Torque* (T)
3. Select the *Socket Hex Size*
4. Select the *Socket Length* required (x)
4. Select the *Hex Tip* required
5. Combine Part Numbers as Shown Below

Example Extended Socket

LTC143T2 - 25B5

LTC14 ----- Basic Tool
3 ----- 0.95" Offset
T2 ----- 15 to 25 in-lbs. Torque Range
25 ----- 1/4" Socket Hex
B --- 1/2" Long Extended Socket
5 - 1/16" Hex Tip

Example Flush

LTC143T2 - 25 - 5

LTC14 ----- Basic Tool
3 ----- 0.95" Offset
T2 ----- 15 to 25 in-lbs. Torque Range
25 ----- 1/4" Flush Socket Hex
5 - 1/16 Hex Tip

Hex Tip	Socket Hex	Complete Part #
1/16	7/32	LTC14(H)(T) - 21(x)5
	1/4	LTC14(H)(T) - 25(x)5
	9/32	LTC14(H)(T) - 28(x)5
	5/16	LTC14(H)(T) - 31(x)5
	11/32	LTC14(H)(T) - 34(x)5
5/64	7/32	LTC14(H)(T) - 21(x)6
	1/4	LTC14(H)(T) - 25(x)6
	9/32	LTC14(H)(T) - 28(x)6
	5/16	LTC14(H)(T) - 31(x)6
	11/32	LTC14(H)(T) - 34(x)6
3/32	3/8	LTC14(H)(T) - 37(x)6
	5/16	LTC14(H)(T) - 31(x)8
	11/32	LTC14(H)(T) - 34(x)8
	3/8	LTC14(H)(T) - 37(x)8
	7/16	LTC14(H)(T) - 43(x)8



Torque Control Tooling

LTC22 Series

0.25" Thick Head - (T2 - T3)

LOK-FAST



H	Head Offset
3	0.95"
5	2.10"

T	Torque Range
T2	15 to 25 in - lbs
T3	26 to 55 in - lbs

X	Socket Length
B	0.5"
D	1.0"
F	1.5"
H	2.0"
L	3.0"
P	4.0"

Tool Data	
Performance Rated @	90 PSI
Air Inlet	1/4 N.P.T.
RPM	T2 - T3 = 600

Ordering Information:

1. Select the *Head Offset* required (H)
2. Select *Nut Setting Torque* (T)
3. Select the *Socket Hex Size* needed
4. Select the *Socket Length* required (x)
4. Select the *Hex Tip* required
5. Combine Part Numbers as Shown Below

Example Extended Socket

LTC223T2 - 25B5

LTC22 ----- Basic Tool
3 ----- 0.95" Offset
T2 ----- 15 to 25 in-lbs. Torque Range
25 ----- 1/4" Socket Hex
B --- 1/2" Long Extended Socket
5 - 1/16" Hex Tip

Hex Tip	Socket Hex	Complete Part #
1/16	7/32	LTC22(H)(T) - 21(x)5
	1/4	LTC22(H)(T) - 25(x)5
	9/32	LTC22(H)(T) - 28(x)5
	5/16	LTC22(H)(T) - 31(x)5
5/64	11/32	LTC22(H)(T) - 34(x)5
	7/32	LTC22(H)(T) - 21(x)6
	1/4	LTC22(H)(T) - 25(x)6
	9/32	LTC22(H)(T) - 28(x)6
3/32	5/16	LTC22(H)(T) - 31(x)6
	11/32	LTC22(H)(T) - 34(x)6
	3/8	LTC22(H)(T) - 37(x)6
	5/16	LTC22(H)(T) - 31(x)8
3/32	11/32	LTC22(H)(T) - 34(x)8
	3/8	LTC22(H)(T) - 37(x)8
	7/16	LTC22(H)(T) - 43(x)8



Torque Control Tooling

LTC23 Series

0.33" Thick Head - (T2 - T4)

LOK-FAST



Ordering Information:

1. Select the *Head Offset* required (H)
2. Select *Nut Setting Torque* (T)
3. Select the *Socket Hex Size* needed
4. Select the *Socket Length* required (x)
4. Select the *Hex Tip* required
5. Combine Part Numbers as Shown Below

Example Extended Socket

LTC233T2 - 25B5

LTC23 ----- Basic Tool
3 ----- 0.95" Offset
T2 ----- 15 to 25 in-lbs. Torque Range
25 ----- 1/4" Socket Hex
B --- 1/2" Long Extended Socket
5 - 1/16" Hex Tip

Example Flush:

LTC233T2 - 25 - 5

LTC23 ----- Basic Tool
3 ----- 0.95" Offset
T2 ----- 15 to 25 in-lbs. Torque Range
25 ----- 1/4" Flush Socket Hex
5 - 1/16 Hex Tip

H	Head Offset
3	0.95"
5	2.10"
7*	3.44"

* Not available above T3

T	Torque Range
T2	15 to 25 in - lbs
T3	26 to 55 in - lbs
T4	40 to 80 in - lbs

X	Socket Length
-	flush
B	0.5"
D	1.0"
F	1.5"
H	2.0"
L	3.0"
P	4.0"

Tool Data	
Performance Rated @	90 PSI
Air Inlet	1/4 N.P.T.
RPM	T2 - T3 = 600 T4 = 400

Hex Tip	Socket Hex	Complete Part #
1/16	7/32	LTC23(H)(T) - 21(x)5
	1/4	LTC23(H)(T) - 25(x)5
	9/32	LTC23(H)(T) - 28(x)5
	5/16	LTC23(H)(T) - 31(x)5
	11/32	LTC23(H)(T) - 34(x)5
5/64	7/32	LTC23(H)(T) - 21(x)6
	1/4	LTC23(H)(T) - 25(x)6
	9/32	LTC23(H)(T) - 28(x)6
	5/16	LTC23(H)(T) - 31(x)6
	11/32	LTC23(H)(T) - 34(x)6
3/32	3/8	LTC23(H)(T) - 37(x)6
	5/16	LTC23(H)(T) - 31(x)8
	11/32	LTC23(H)(T) - 34(x)8
	3/8	LTC23(H)(T) - 37(x)8
	7/16	LTC23(H)(T) - 43(x)8



Torque Control Tooling

LTC24 Series

0.46" Thick Head - (T2 - T5)

LOK-FAST



H	Head Offset
3	0.95"
5	2.10"
7	3.44"

T	Torque Range
T2	15 to 25 in - lbs
T3	26 to 55 in - lbs
T4	40 to 80 in - lbs
T5	80 to 120 in - lbs

X	Socket Length
-	flush
B	0.5"
D	1.0"
F	1.5"
H	2.0"
L	3.0"
P	4.0"

Tool Data

Performance Rated @	90 PSI
Air Inlet	1/4 N.P.T.
RPM	T2 - T3 = 600 T4 - T5 = 400

Ordering Information:

1. Select the *Head Offset* required (H)
2. Select *Nut Setting Torque* (T)
3. Select the *Socket Hex Size*
4. Select the *Socket Length* required (x)
4. Select the *Hex Tip* required
5. Combine Part Numbers as Shown Below

Example Extended Socket

LTC243T2 - 25B5

LTC24 ----- Basic Tool
3 ----- 0.95" Offset
T2 ----- 15 to 25 in-lbs. Torque Range
25 ----- 1/4" Socket Hex
B --- 1/2" Long Extended Socket
5 - 1/16" Hex Tip

Example Flush

LTC243T2 - 25 - 5

LTC24 ----- Basic Tool
3 ----- 0.95" Offset
T2 ----- 15 to 25 in-lbs. Torque Range
25 ----- 1/4" Flush Socket Hex
5 - 1/16 Hex Tip

Hex Tip	Socket Hex	Complete Part #
1/16	7/32	LTC24(H)(T) - 21(x)5
	1/4	LTC24(H)(T) - 25(x)5
	9/32	LTC24(H)(T) - 28(x)5
	5/16	LTC24(H)(T) - 31(x)5
5/64	11/32	LTC24(H)(T) - 34(x)5
	7/32	LTC24(H)(T) - 21(x)6
	1/4	LTC24(H)(T) - 25(x)6
	9/32	LTC24(H)(T) - 28(x)6
3/32	5/16	LTC24(H)(T) - 31(x)6
	11/32	LTC24(H)(T) - 34(x)6
	3/8	LTC24(H)(T) - 37(x)6
	5/16	LTC24(H)(T) - 31(x)8
3/8	11/32	LTC24(H)(T) - 34(x)8
	3/8	LTC24(H)(T) - 37(x)8
	7/16	LTC24(H)(T) - 43(x)8



Torque Control Tooling

LTC300 Series

(T2 - T5)

LOK-FAST



Ordering Information:

1. Select the *Nut Setting Torque (T)*
2. Select the *Socket Hex Size*
3. Select the *Socket Length* required (x)
4. Select the *Hex Tip*
5. Combine Part Numbers as Shown Below

Example: **LTC300T2 - 25H5**

LTC300 ----- Basic Tool
T2 ----- 15 to 25 in-lbs. Torque Range
25 ----- 1/4" Socket Hex
H ---- 2" Long Extended Socket
5 - 1/16" Hex Tip

T	Torque Range
T2	15 to 25 in - lbs
T3	26 to 55 in - lbs
T4	40 to 80 in - lbs
T5	80 to 120 in - lbs

X	Socket Length
H	2.0"
P	4.0"

Tool Data	
Performance Rated @	90 PSI
Air Inlet	1/4 N.P.T.
RPM	T2 - T3 = 600 T4 - T5 = 400

Hex Tip	Socket Hex	Complete Part #
1/16	7/32	LTC300(T) - 21(x)5
	1/4	LTC300(T) - 25(x)5
	9/32	LTC300(T) - 28(x)5
	5/16	LTC300(T) - 31(x)5
	11/32	LTC300(T) - 34(x)5
5/64	7/32	LTC300(T) - 21(x)6
	1/4	LTC300(T) - 25(x)6
	9/32	LTC300(T) - 28(x)6
	5/16	LTC300(T) - 31(x)6
	11/32	LTC300(T) - 34(x)6
3/8	3/8	LTC300(T) - 37(x)6
	5/16	LTC300(T) - 31(x)8
	11/32	LTC300(T) - 34(x)8
	3/8	LTC300(T) - 37(x)8
3/32	7/16	LTC300(T) - 43(x)8



Torque Control Tooling

LTC42 Series

0.25" Thick Head - (T2 - T3)

LOK-FAST



Ordering Information:

1. Select the *Head Offset* required (H)
2. Select *Nut Setting Torque* (T)
3. Select the *Socket Hex Size*
4. Select the *Socket Length* required (x)
4. Select the *Hex Tip* required
5. Combine Part Numbers as Shown Below

Example Extended Socket

LTC423T2 - 25B5

LTC42 ----- Basic Tool
3 ----- 0.95" Offset
T2 ----- 15 to 25 in-lbs. Torque Range
25 ----- 1/4" Socket Hex
B ---- 1/2" Long Extended Socket
5 - 1/16" Hex Tip

H	Head Offset
3	0.95"
5	2.10"

T	Torque Range
T2	15 to 25 in - lbs
T3	26 to 55 in - lbs

X	Socket Length
B	0.5"
D	1.0"
F	1.5"
H	2.0"
L	3.0"
P	4.0"

Tool Data	
Performance Rated @	90 PSI
Air Inlet	1/4 N.P.T.
RPM	T2 = 600 T3 = 400

Hex Tip	Socket Hex	Complete Part #
1/16	7/32	LTC42(H)(T) - 21(x)5
	1/4	LTC42(H)(T) - 25(x)5
	9/32	LTC42(H)(T) - 28(x)5
	5/16	LTC42(H)(T) - 31(x)5
	11/32	LTC42(H)(T) - 34(x)5
5/64	7/32	LTC42(H)(T) - 21(x)6
	1/4	LTC42(H)(T) - 25(x)6
	9/32	LTC42(H)(T) - 28(x)6
	5/16	LTC42(H)(T) - 31(x)6
	11/32	LTC42(H)(T) - 34(x)6
3/32	3/8	LTC42(H)(T) - 37(x)6
	5/16	LTC42(H)(T) - 31(x)8
	11/32	LTC42(H)(T) - 34(x)8
	3/8	LTC42(H)(T) - 37(x)8
	7/16	LTC42(H)(T) - 43(x)8



Torque Control Tooling

LTC43 Series

0.33" Thick Head - (T2 - T4)



Ordering Information:

1. Select the *Head Offset* required (H)
2. Select Nut Setting *Torque* (T)
3. Select the *Socket Hex Size*
4. Select the *Socket Length* required (x)
4. Select the *Hex Tip* required
5. Combine Part Numbers as Shown Below

Example Extended Socket

LTC433T2 - 25B5

LTC43 ----- Basic Tool
3 ----- 0.95" Offset
T2 ----- 15 to 25 in-lbs. Torque Range
25 ----- 1/4" Socket Hex
B --- 1/2" Long Extended Socket
5 - 1/16" Hex Tip.

Example Flush

LTC433T2 - 25 - 5

LTC43 ----- Basic Tool
3 ----- 0.95" Offset
T2 ----- 15 to 25 in-lbs. Torque Range
25 ----- 1/4" Flush Socket Hex
5 - 1/16 Hex Tip

H	Head Offset
3	0.95"
5	2.10"
7*	3.44"

* Not available above T3

T	Torque Range
T2	15 to 25 in - lbs
T3	26 to 55 in - lbs
T4	40 to 80 in - lbs

X	Socket Length
-	flush
B	0.5"
D	1.0"
F	1.5"
H	2.0"
L	3.0"
P	4.0"

Tool Data	
Performance Rated @	90 PSI
Air Inlet	1/4 N.P.T.
RPM	T2 = 600 T3 - T4 = 400

Hex Tip	Socket Hex	Complete Part #
	7/32	L
	1/4	LTC43(H)(T) - 25(x)5
1/16	9/32	LTC43(H)(T) - 28(x)5
	5/16	LTC43(H)(T) - 31(x)5
	11/32	LTC43(H)(T) - 34(x)5
	7/32	LTC43(H)(T) - 21(x)6
5/64	1/4	LTC43(H)(T) - 25(x)6
	9/32	LTC43(H)(T) - 28(x)6
	5/16	LTC43(H)(T) - 31(x)6
	11/32	LTC43(H)(T) - 34(x)6
	3/8	LTC43(H)(T) - 37(x)6
	5/16	LTC43(H)(T) - 31(x)8
3/32	11/32	LTC43(H)(T) - 34(x)8
	3/8	LTC43(H)(T) - 37(x)8
	7/16	LTC43(H)(T) - 43(x)8



Torque Control Tooling

LTC44 Series

0.46" Thick Head - (T2 - T5)



Ordering Information:

1. Select the *Head Offset* required (H)
2. Select *Nut Setting Torque* (T)
3. Select the *Socket Hex Size*
4. Select the *Socket Length* required (x)
4. Select the *Hex Tip* required
5. Combine Part Numbers as Shown Below

Example Extended Socket

LTC443T2 - 25B5

LTC44 ----- Basic Tool
3 ----- 0.95" Offset
T2 ----- 15 to 25 in-lbs. Torque Range
25 ----- 1/4" Socket Hex
B --- 1/2" Long Extended Socket
5 - 1/16" Hex Tip

Example Flush

LTC443T2 - 25 - 5

LTC44 ----- Basic Tool
3 ----- 0.95" Offset
T2 ----- 15 to 25 in-lbs. Torque Range
25 ----- 1/4" Flush Socket Hex
5 - 1/16 Hex Tip

H	Head Offset
3	0.95"
5	2.10"
7	3.44"

T	Torque Range
T2	15 to 25 in - lbs
T3	26 to 55 in - lbs
T4	40 to 80 in - lbs
T5	80 to 120 in - lbs

X	Socket Length
-	flush
B	0.5"
D	1.0"
F	1.5"
H	2.0"
L	3.0"
P	4.0"

Tool Data	
Performance Rated @	90 PSI
Air Inlet	1/4 N.P.T.
RPM	T2 = 600
	T3 - T4 = 400
	T5 = 350

Hex Tip	Socket Hex	Complete Part #
1/16	7/32	LTC44(H)(T) - 21(x)5
	1/4	LTC44(H)(T) - 25(x)5
	9/32	LTC44(H)(T) - 28(x)5
	5/16	LTC44(H)(T) - 31(x)5
	11/32	LTC44(H)(T) - 34(x)5
5/64	7/32	LTC44(H)(T) - 21(x)6
	1/4	LTC44(H)(T) - 25(x)6
	9/32	LTC44(H)(T) - 28(x)6
	5/16	LTC44(H)(T) - 31(x)6
	11/32	LTC44(H)(T) - 34(x)6
3/32	3/8	LTC44(H)(T) - 37(x)6
	5/16	LTC44(H)(T) - 31(x)8
	11/32	LTC44(H)(T) - 34(x)8
	3/8	LTC44(H)(T) - 37(x)8
	7/16	LTC44(H)(T) - 43(x)8



Torque Control Tooling

LTC52 Series

0.25" Thick Head - (T2 - T3)

LOK-FAST



Ordering Information:

1. Select the *Head Offset* required (H)
2. Select *Nut Setting Torque* (T)
3. Select the *Socket Hex Size*
4. Select the *Socket Length* required (x)
4. Select the *Hex Tip* required
5. Combine Part Numbers as Shown Below

Example Extended Socket

LTC523T2 - 25B5

LTC52 ----- Basic Tool
3 ----- 0.95" Offset
T2 ----- 15 to 25 in-lbs. Torque Range
25 ----- 1/4" Socket Hex
B --- 1/2" Long Extended Socket
5 - 1/16" Hex Tip

H	Head Offset
3	0.95"
5	2.10"

T	Torque Range
T2	15 to 25 in - lbs
T3	26 to 55 in - lbs

X	Socket Length
B	0.5"
D	1.0"
F	1.5"
H	2.0"
L	3.0"
P	4.0"

Tool Data	
Performance Rated @	90 PSI
Air Inlet	1/4 N.P.T.
RPM	T2 = 600 T3 = 400

Hex Tip	Socket Hex	Complete Part #
1/16	7/32	LTC52(H)(T) - 21(x)5
	1/4	LTC52(H)(T) - 25(x)5
	9/32	LTC52(H)(T) - 28(x)5
	5/16	LTC52(H)(T) - 31(x)5
	11/32	LTC52(H)(T) - 34(x)5
5/64	7/32	LTC52(H)(T) - 21(x)6
	1/4	LTC52(H)(T) - 25(x)6
	9/32	LTC52(H)(T) - 28(x)6
	5/16	LTC52(H)(T) - 31(x)6
	11/32	LTC52(H)(T) - 34(x)6
3/32	3/8	LTC52(H)(T) - 37(x)6
	5/16	LTC52(H)(T) - 31(x)8
	11/32	LTC52(H)(T) - 34(x)8
	7/16	LTC52(H)(T) - 43(x)8



Torque Control Tooling

LTC53 Series

0.33" Thick Head - (T2 - T4)

LOK-FAST



Ordering Information:

1. Select the *Head Offset* required (H)
2. Select *Nut Setting Torque* (T)
3. Select the *Socket Hex Size*
4. Select the *Socket Length* required (x)
4. Select the *Hex Tip* required
5. Combine Part Numbers as Shown Below

Example Extended Socket

LTC533T2 - 25B5

LTC53 ----- Basic Tool
3 ----- 0.95" Offset
T2 ----- 15 to 25 in-lbs. Torque Range
25 ----- 1/4" Socket Hex
B --- 1/2" Long Extended Socket
5 - 1/16" Hex Tip

Example Flush

LTC533T2 - 25 - 5

LTC53 ----- Basic Tool
3 ----- 0.95" Offset
T2 ----- 15 to 25 in-lbs. Torque Range
25 ----- 1/4" Flush Socket Hex
5 - 1/16 Hex Tip

H	Head Offset
3	0.95"
5	2.10"
7*	3.44"

* Not available above T3

T	Torque Range
T2	15 to 25 in - lbs
T3	26 to 55 in - lbs
T4	40 to 80 in - lbs

X	Socket Length
-	flush
B	0.5"
D	1.0"
F	1.5"
H	2.0"
L	3.0"
P	4.0"

Tool Data	
Performance Rated @	90 PSI
Air Inlet	1/4 N.P.T.
RPM	T2 = 600 T3 - T4 = 400

Hex Tip	Socket Hex	Complete Part #
1/16	7/32	LTC53(H)(T) - 21(x)5
	1/4	LTC53(H)(T) - 25(x)5
	9/32	LTC53(H)(T) - 28(x)5
	5/16	LTC53(H)(T) - 31(x)5
	11/32	LTC53(H)(T) - 34(x)5
5/64	7/32	LTC53(H)(T) - 21(x)6
	1/4	LTC53(H)(T) - 25(x)6
	9/32	LTC53(H)(T) - 28(x)6
	5/16	LTC53(H)(T) - 31(x)6
	11/32	LTC53(H)(T) - 34(x)6
3/32	3/8	LTC53(H)(T) - 37(x)6
	5/16	LTC53(H)(T) - 31(x)8
	11/32	LTC53(H)(T) - 34(x)8
	3/8	LTC53(H)(T) - 37(x)8
	7/16	LTC53(H)(T) - 43(x)8



Torque Control Tooling

LTC54 Series

0.46" Thick Head - (T2 - T5)



Ordering Information:

1. Select the *Head Offset* required (H)
2. Select *Nut Setting Torque* (T)
3. Select the *Socket Hex Size*
4. Select the *Socket Length* required (x)
4. Select the *Hex Tip* required
5. Combine Part Numbers as Shown Below

Example Extended Socket

LTC543T2 - 25B5

LTC54 ----- Basic Tool

3 ----- 0.95" Offset

T2 ----- 15 to 25 in-lbs. Torque Range

25 ----- 1/4" Socket Hex

B --- 1/2" Long Extended Socket

5 - 1/16" Hex Tip

Example Flush

LTC543T2 - 25 - 5

LTC54 ----- Basic Tool

3 ----- 0.95" Offset

T2 ----- 15 to 25 in-lbs. Torque Range

25 ----- 1/4" Flush Socket Hex

5 - 1/16 Hex Tip

H	Head Offset
3	0.95"
5	2.10"
7	3.44"

T	Torque Range
T2	15 to 25 in - lbs
T3	26 to 55 in - lbs
T4	40 to 80 in - lbs
T5	80 to 120 in - lbs

X	Socket Length
-	flush
B	0.5"
D	1.0"
F	1.5"
H	2.0"
L	3.0"
P	4.0"

Tool Data	
Performance Rated @	90 PSI
Air Inlet	1/4 N.P.T.
RPM	T2 = 600
	T3 - T4 = 400
	T5 = 350

Hex Tip	Socket Hex	Complete Part #
1/16	7/32	LTC54(H)(T) - 21(x)5
	1/4	LTC54(H)(T) - 25(x)5
	9/32	LTC54(H)(T) - 28(x)5
	5/16	LTC54(H)(T) - 31(x)5
	11/32	LTC54(H)(T) - 34(x)5
5/64	7/32	LTC54(H)(T) - 21(x)6
	1/4	LTC54(H)(T) - 25(x)6
	9/32	LTC54(H)(T) - 28(x)6
	5/16	LTC54(H)(T) - 31(x)6
	11/32	LTC54(H)(T) - 34(x)6
3/32	3/8	LTC54(H)(T) - 37(x)6
	5/16	LTC54(H)(T) - 31(x)8
	11/32	LTC54(H)(T) - 34(x)8
	3/8	LTC54(H)(T) - 37(x)8
	7/16	LTC54(H)(T) - 43(x)8



Torque Control Tooling

LTC600 Series

(T2 - T5)



Ordering Information:

1. Select the *Head Offset* required (H)
2. Select *Nut Setting Torque* (T)
3. Select the *Socket Hex Size*
4. Select the *Socket Length* required (x)
4. Select the *Hex Tip* required
5. Combine Part Numbers as Shown Below

Example: **LTC600T2 - 25D5**

LTC600 ----- Basic Tool
T2 ----- 15 to 25 in-lbs. Torque Range
25 ----- 1/4" Socket Hex
D --- 1" Long Extended Socket
5 - 1/16" Hex Tip

T	Torque Range
T2	15 to 25 in - lbs
T3	26 to 55 in - lbs
T4	40 to 80 in - lbs
T5	80 to 120 in - lbs

X	Socket Length
D	1.0"
F	1.5"
H	2.0"
L	3.0"
P	4.0"

Tool Data	
Performance Rated @	90 PSI
Air Inlet	1/4 N.P.T.
RPM	T2 = 600 T3 - T4 = 400 T5 = 350

Hex Tip	Socket Hex	Complete Part #
1/16	7/32	LTC600(T) - 21(x)5
	1/4	LTC600(T) - 25(x)5
	9/32	LTC600(T) - 28(x)5
	5/16	LTC600(T) - 31(x)5
	11/32	LTC600(T) - 34(x)5
5/64	7/32	LTC600(T) - 21(x)6
	1/4	LTC600(T) - 25(x)6
	9/32	LTC600(T) - 28(x)6
	5/16	LTC600(T) - 31(x)6
	11/32	LTC600(T) - 34(x)6
	3/8	LTC600(T) - 37(x)6
3/32	5/16	LTC600(T) - 31(x)8
	11/32	LTC600(T) - 34(x)8
	3/8	LTC600(T) - 37(x)8
	7/16	LTC600(T) - 43(x)8



Cordless Electric Tooling Systems

Torque Control Tools

LTCB Series



Our new Cordless Electric tools with Torque Control Fastening bring to you the following benefits:

- Ergonomic,
- Convenience,
- Accuracy
- Wide range of process monitoring
- At real time capabilities
- RPM programmable via USB

Battery & Charger Sold Separately
Please specify charger voltage when ordering

TORQUE RATING*

T2	=	15 to 25 in-lbs
T3	=	26 to 55 in-lbs
T4	=	55 to 80 in-lbs
T5	=	80 to 100 in-lbs

LOK-FAST



Cordless Electric Tooling Systems

Torque Control Tools

LTCB - - -

STYLE

1		2	
3		4	
5		6	

TOOL BRAND

Makita = MK
Atlas Copco = AC
Ingersoll-Rand = IR
Bosch = BH

HEAD THICKNESS

2 = 0.25"
3 = 0.33"
4 = 0.46"

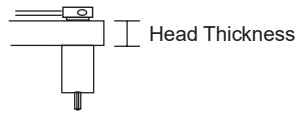

HEAD OFFSET

3 = 0.95"
5 = 2.10"
7 = 3.44"

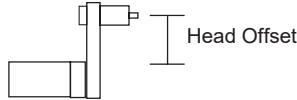

TORQUE RATING*

T2 = 15 to 25 in-lbs
T3 = 26 to 55 in-lbs
T4 = 40 to 80 in-lbs
T5 = 80 to 120 in-lbs

Important to note not all torque ratings are available for all head thicknesses and offsets. Refer to specific tool pages for details.

SOCKET HEX SIZE

7/32 = 21
1/4 = 25
9/32 = 28
5/16 = 31
11/32 = 34



SOCKET LENGTH

- = flush
B = 0.5"
D = 1.0"
F = 1.5"
H = 2.0"
L = 3.0"
P = 4.0"

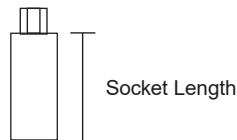

HEX TIP

5 = 1/16
6 = 5/64
8 = 3/32

